



Illinois Department
of Transportation

RETURN WITH BID

Local Public Agency
Material Proposal or
Deliver & Install
Proposal

PROPOSAL SUBMITTED BY		
Contractor's Name		
Street	P.O. Box	
City	State	Zip Code

STATE OF ILLINOIS

COUNTY OF Menard

Road Districts 1-2-3-4-5-6-7-9 & 10

(Name of City, Village, Town or Road District)

FOR THE IMPROVEMENT OF

STREET NAME OR ROUTE NO. _____

SECTION NO. 21-XX000-00-GM

TYPES OF FUNDS Twp. M.F.T.

☒ MATERIAL PROPOSAL
☒ SPECIFICATIONS (required)

☐ DELIVER & INSTALL PROPOSAL
☐ PLANS (if applicable)

For Municipal Projects

Submitted/Approved/Passed

☐ Mayor ☐ President of Board of Trustees ☐ Municipal Official

Date

Department of Transportation

☒ Released for bid based on limited review

P. P. P.
Regional Engineer

2.3.21
Date

For County and Road District Projects

Submitted/Approved

Highway Commissioner

Date

Submitted/Approved

C. A. R.
County Engineer/Superintendent of Highways

1/15/2021
Date

Note: All proposal documents, including Proposal Guaranty Checks or Proposal Bid Bonds, should be stapled together to prevent loss when bids are processed.

RETURN WITH BID

NOTICE TO BIDDERS

County Menard
 Local Public Agency Various Rd. Dists
 Section Number 21-XX000-00-GM
 Route _____

Sealed proposals for the furnishing or delivering & installing materials required in the construction/maintenance of the above Section will be received and at that time publicly opened and read at the office of Menard County Highway Dept.,
15620 Chautauqua Road until 10:30 AM on February 19, 2021
 Address Time Date

1. Plans and proposal forms will be available in the office of Menard County Highway Department
15620 Chautauqua Road, Petersburg IL 62675
 Address
2. ☐ Prequalification. If checked, the 2 low bidders must file within 24 hours after the letting an "Affidavit of Availability" (Form BC 57), in duplicate, showing all uncompleted contracts awarded to them and all low bids pending award for Federal, State, County, Municipal and private work.
3. The Awarding Authority reserves the right to waive technicalities and to reject any or all proposals as provided in BLRS Special Provision for Bidding Requirements and Conditions for Material Proposals.
4. A proposal guaranty in the proper amount, as specified in BLRS Special Provision for Bidding Requirements and Conditions for Material Proposals, will be required. Bid Bonds will not be allowed as a proposal guaranty.
5. The successful bidder at the time of execution of the contract will not be required to deposit a contract bond for the full amount of the award. When a contract bond is not required, the proposal guaranty check will be held in lieu thereof. Failure on the part of the contractor to deliver the material within the time specified or to do the work specified herein will be considered just cause to forfeit his surety as provided in Article 108.10 of the Standard Specifications.
6. Proposals shall be submitted on forms furnished by the Awarding Authority and shall be enclosed in an envelope endorsed "Material Proposal, Section 21-XX000-00-GM".

By Order of Menard Co. Board of Commissioners 01/07/2021 Corey A. Dowd, County Engineer
 (Awarding Authority) Date (County Engineer/Superintendent of Highways/Municipal Clerk)

Material Proposal or Deliver & Install Proposal

To Menard Co. Board of Commissioners
 (Awarding Authority)

If this bid is accepted within 45 days from date of opening, the undersigned agrees to furnish or to deliver & install any or all of the materials, at the quoted unit prices, subject to the following:

1. It is understood and agreed that the "Standard Specifications for Road and Bridge Construction", adopted April 1, 2016, and the "Supplemental Specifications and Recurring Special Provisions", adopted January 1, 2021, prepared by the Department of Transportation, shall govern insofar as they may be applied and insofar as they do not conflict with the special provisions and supplemental specifications attached hereto.
2. It is understood that quantities listed are approximate only and that they may be increased or decreased as may be needed to properly complete the improvement within its present limits or extensions thereto, at the unit price stated and that bids will be compared on the basis of the total price bid for each group.
3. Delivery in total or partial shipments as ordered shall be made within the time specified in the special provisions or by the acceptance at the point and in the manner specified in the "Schedule of Prices". If delivery on the job site is specified, it shall mean any place or places on the road designated by the awarding authority or its authorized representative.
4. The contractor and/or local agency performing the actual material placement operations shall be responsible for providing work zone traffic control, unless otherwise specified in this proposal. Such devices shall meet the requirements of and be installed in accordance with applicable provisions of the "Illinois Manual on Uniform Traffic Control Devices" and any referenced Illinois Highway Standards.
5. Each pay item should have a unit price and a total price. If no total price is shown or if there is a discrepancy between the product of the unit price multiplied by the quantity, the unit price shall govern. If a unit price is omitted, the total price will be divided by the quantity in order to establish a unit price. A bid will be declared unacceptable if neither a unit price nor a total price is shown.

Discounts will be allowed for payment as follows: 0 % 0 calendar days: 0 % 0 calendar days.

Discounts will not be considered in determining the low bidder.

Bidder _____

By _____
 (Signature)

Address _____

Title _____



Group No.	Items	Delivery	Unit	Quantity	Unit Price	Total
	Road Dist. #1 21-01000-00-GM					
1.	Seal Coat Aggregate (Furnished)					
	CA-16 (Gravel)	FOB Source	Ton	1,500		
	Source Location:					
2.	Aggregate Surface Course					
	Type B (CA-6) Low PI	FOB Source	Ton	500		
	Source Location:					
	Road Dist. #2 21-02000-00-GM					
3.	Seal Coat Aggregate (Furnished)					
	CA-16 (Crushed Stone)	FOB Stockpile	Ton	1,200		
4.	Aggregate Surface Course					
	Type B (CA-6), Low PI	FOB Source	Ton	150		
	Source Location:					
5.	Aggregate Surface Course					
	Type B (CM-9)	FOB Stockpile	Ton	1,200		
6.	Aggregate Surface Course					
	Type B (CM-9) Furnished and					
	Applied	FOB Jobsite	Ton	1,200		
	Road Dist. #3 21-03000-00-GM					
7.	Seal Coat Aggregate (Furnished)					
	CA-16 (Gravel)	FOB Source	Ton	1,000		
	Source Location:					
8.	Aggregate Surface Course					
	Type B (CA-6), Low PI	FOB Source	Ton	200		
	Source Location:					

The undersigned firm certifies that it has not been convicted of bribery or attempting to bribe an officer or employee of the State of Illinois, nor has the firm made an admission of guilt of such conduct which is a matter of record, nor has an official, agent or employee of the firm committed bribery or attempted bribery on behalf of the firm and pursuant to the direction or authorization of a responsible official of the firm. The undersigned firm further certifies that it is not barred from contracting with any unit of State or local government as a result of a violation of State laws prohibiting bid-rigging or bid rotating.

Signature of Bidder

Address



Group No.	Items	Delivery	Unit	Quantity	Unit Price	Total
	Road Dist. #4 21-04000-00-GM					
9.	Seal Coat Aggregate (Furnished)					
	CA-16 (Crushed Stone)	FOB Stockpile	Ton	1,000		
	Road Dist. #5 21-05000-00-GM					
10.	Seal Coat Aggregate (Furnished)					
	CA-16 (Gravel)	FOB Stockpile	Ton	750		
11.	Seal Coat Aggregate (Furnished)					
	CA-16 (Gravel)	FOB Source	Ton	750		
	Source Location:					
12.	Seal Coat Aggregate (Furnished)					
	FA-4	FOB Stockpile	Ton	150		
13.	Seal Coat Aggregate (Furnished)					
	FA-4	FOB Source	Ton	150		
	Source Location:					
14.	Aggregate Surface Course					
	Type B (CA-6), Low PI	FOB Stockpile	Ton	1,000		
15.	Course Aggregate 2" (Crushed					
	Stone)	FOB Stockpile	Ton	200		
	Road Dist. #6 21-06000-00-GM					
16.	Seal Coat Aggregate (Furnished)					
	CA-16 (Crushed Stone)	FOB Stockpile	Ton	1,000		
17.	Seal Coat Aggregate (Furnished)					
	CA-13 (Crushed Stone)	FOB Stockpile	Ton	600		
18.	Aggregate Surface Course					
	Type B (CA-6), Low PI	FOB Stockpile	Ton	500		

The undersigned firm certifies that it has not been convicted of bribery or attempting to bribe an officer or employee of the State of Illinois, nor has the firm made an admission of guilt of such conduct which is a matter of record, nor has an official, agent or employee of the firm committed bribery or attempted bribery on behalf of the firm and pursuant to the direction or authorization of a responsible official of the firm. The undersigned firm further certifies that it is not barred from contracting with any unit of State or local government as a result of a violation of State laws prohibiting bid-rigging or bid rotating.

Signature of Bidder

Address



Group No.	Items	Delivery	Unit	Quantity	Unit Price	Total
19.	Aggregate Surface Course					
	Type B (CA-7)	FOB Stockpile	Ton	500		
20.	Aggregate Surface Course					
	Type B (CM-2), 2" rock	FOB Stockpile	Ton	500		
	Road Dist. #7 21-07000-00-GM					
21.	Seal Coat Aggregate (Furnished)					
	CM-16 (Crushed Stone)	FOB Stockpile	Ton	500		
22.	Seal Coat Aggregate (Furnished)					
	CM-13 (Crushed Stone)	FOB Stockpile	Ton	500		
23.	Aggregate Surface Course					
	Type B (CM-9)	FOB Stockpile	Ton	500		
	Road Dist. #9 21-09000-00-GM					
24.	Seal Coat Aggregate (Furnished)					
	CA-16 (Crushed Stone)	FOB Stockpile	Ton	1,100		
	Stockpile #2					
25.	Aggregate Surface Course					
	Type B (CA-6)	FOB Stockpile	Ton	200		
	Stockpile #1					
26.	Seal Coat Aggregate (Furnished)					
	CM-13 (Crushed Stone)	FOB Stockpile	Ton	250		
	Stockpile #3					
	Road Dist. #10 21-10000-00-GM					
27.	Seal Coat Aggregate (Furnished)					
	CA-16 (Gravel)	FOB Source	Ton	1,200		

The undersigned firm certifies that it has not been convicted of bribery or attempting to bribe an officer or employee of the State of Illinois, nor has the firm made an admission of guilt of such conduct which is a matter of record, nor has an official, agent or employee of the firm committed bribery or attempted bribery on behalf of the firm and pursuant to the direction or authorization of a responsible official of the firm. The undersigned firm further certifies that it is not barred from contracting with any unit of State or local government as a result of a violation of State laws prohibiting bid-rigging or bid rotating.

Signature of Bidder

Address



Material Proposal Schedule of Prices

[illegible]

The undersigned firm certifies that it has not been convicted of bribery or attempting to bribe an officer or employee of the State of Illinois, nor has the firm made an admission of guilt of such conduct which is a matter of record, nor has an official, agent or employee of the firm committed bribery or attempted bribery on behalf of the firm and pursuant to the direction or authorization of a responsible official of the firm. The undersigned firm further certifies that it is not barred from contracting with any unit of State or local government as a result of a violation of State laws prohibiting bid-rigging or bid rotating.

Signature of Bidder

Address

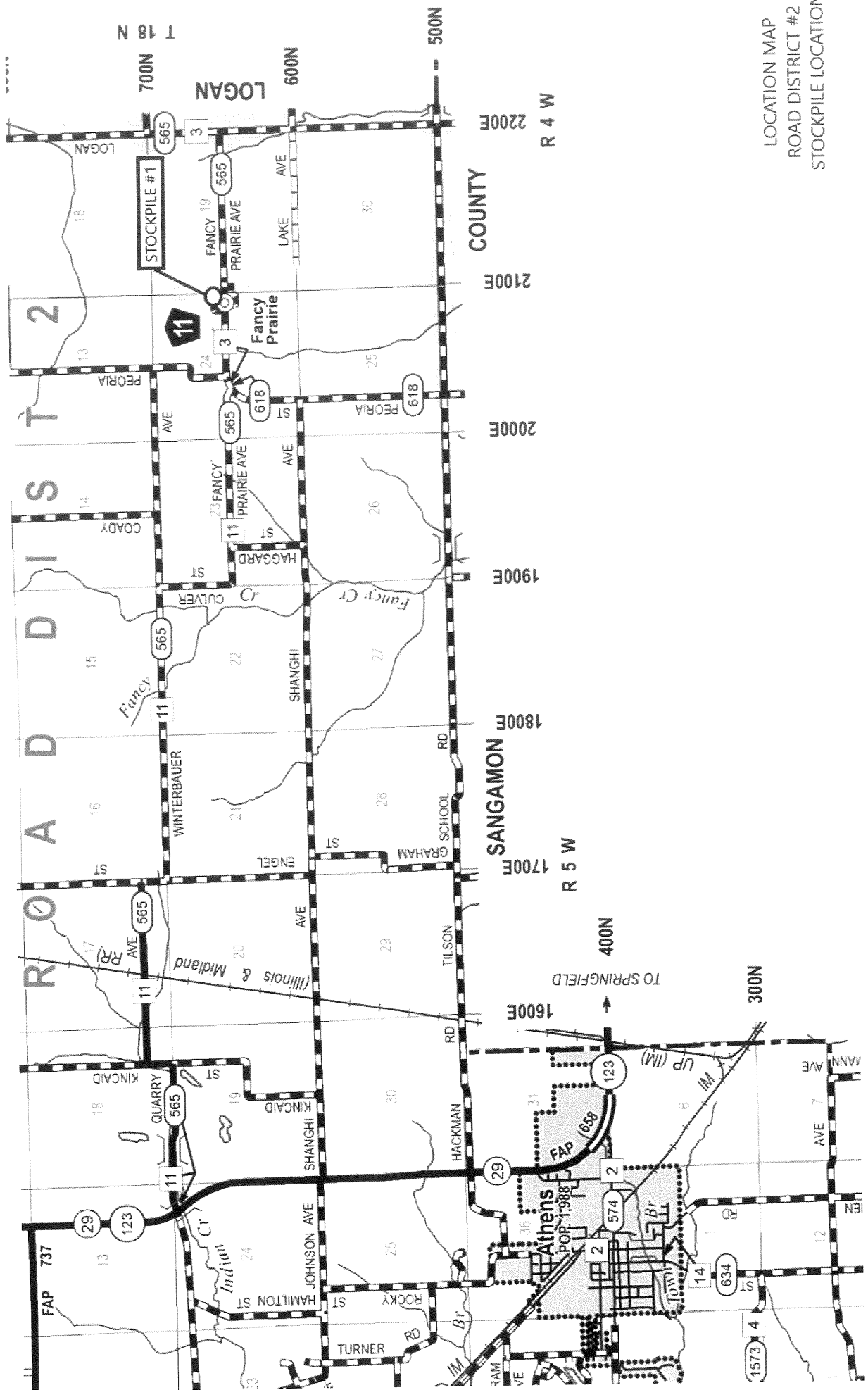

LOCATION MAP
ROAD DISTRICT #2
STOCKPILE LOCATION

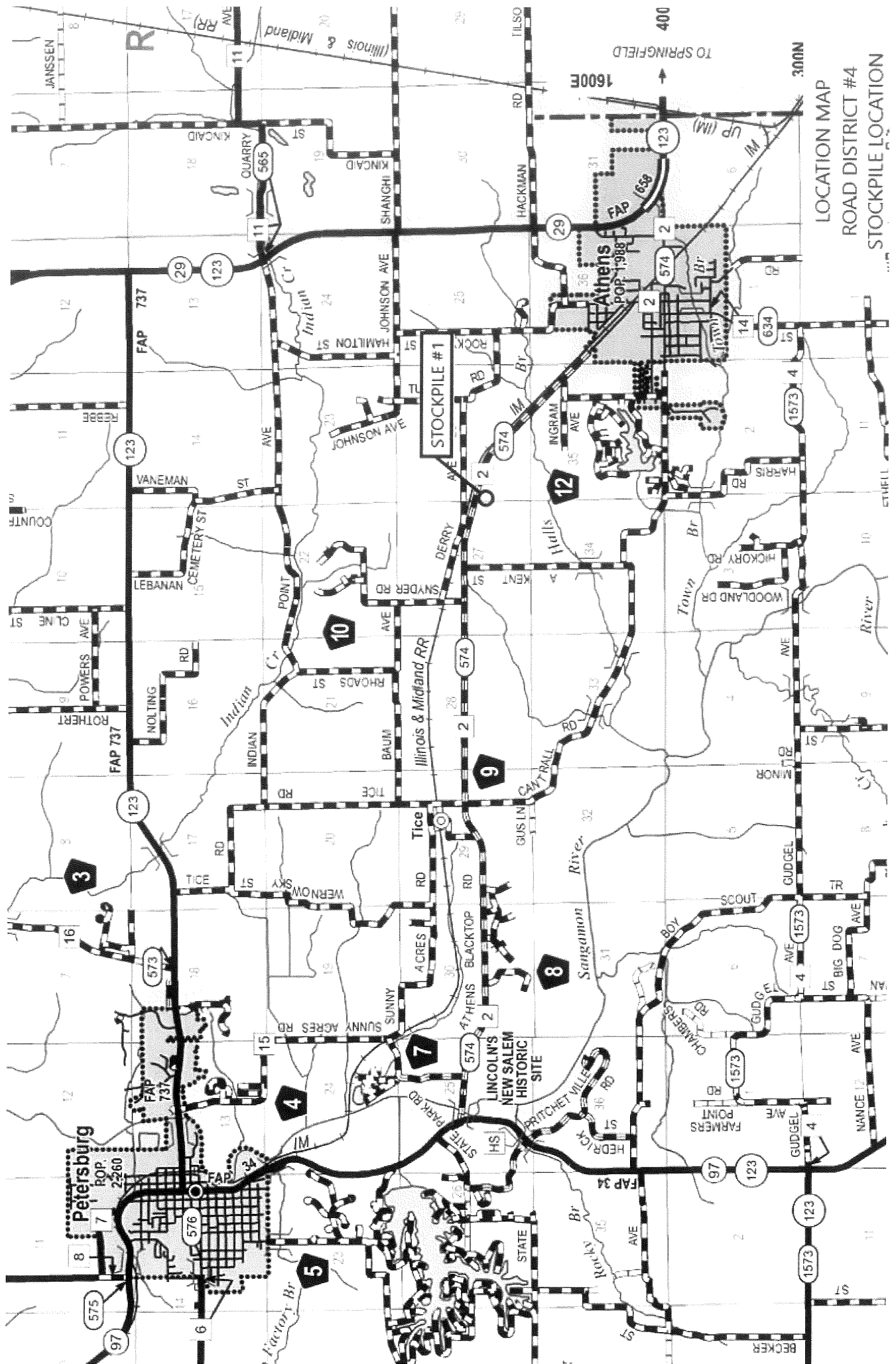

LOCATION MAP
ROAD DISTRICT #4
STOCKPILE LOCATION

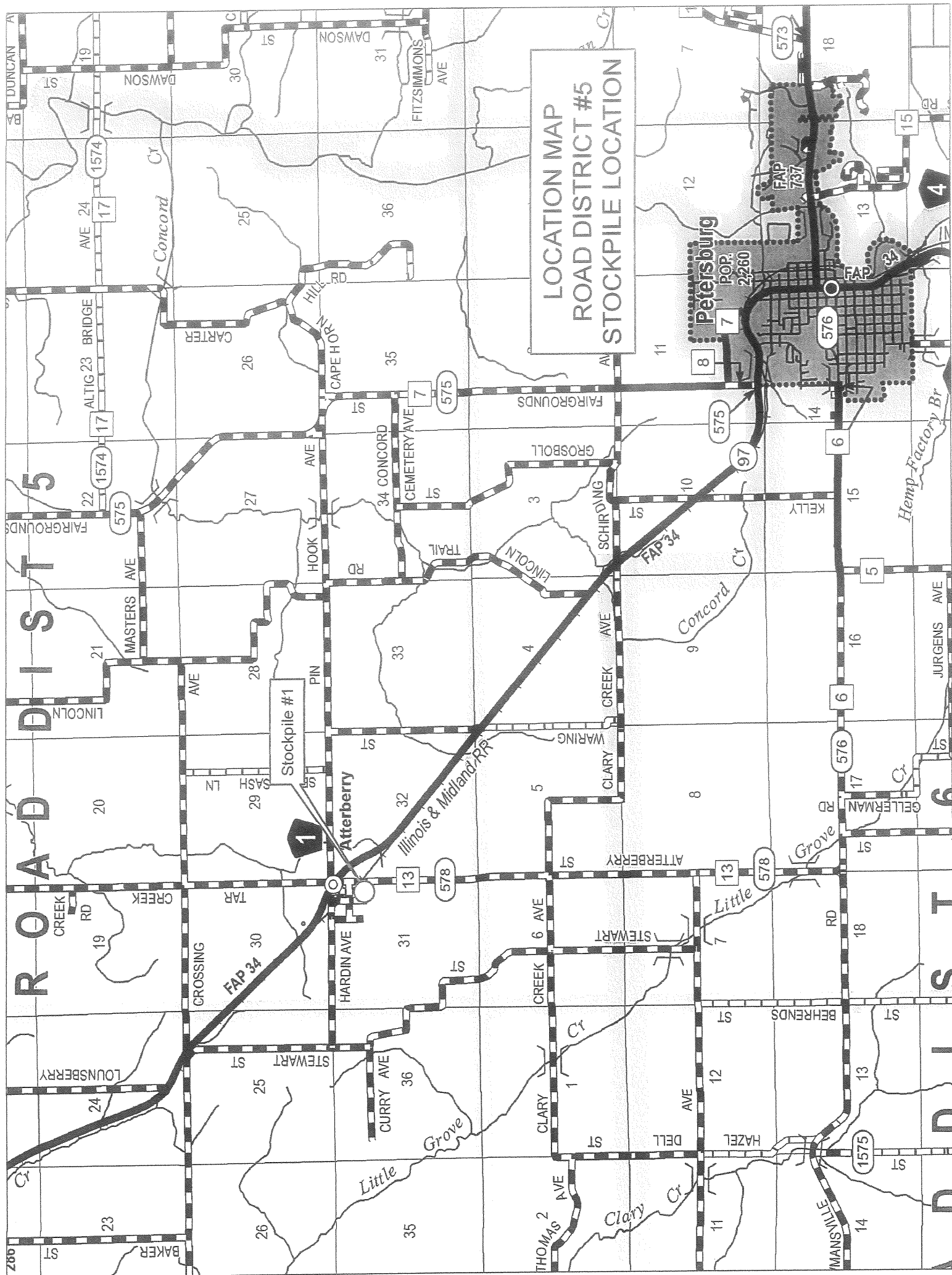

LOCATION MAP
ROAD DISTRICT #5
STOCKPILE LOCATION

Stockpile #1

Atterberry

Petersburg

POP. 2,260

FAP 34

Little

Grove

Clary

Mansville

Jurgens Ave

Hemp Factory Br

Fairgrounds

Grosboll

Schirong

Creek Ave

Clary

Waring

Atterberry

Stewart

Little

Grove

Clary

Stewart

Curry Ave

Hardin Ave

Atterberry

Clary

Thomas Ave

Fairgrounds

Grosboll

Schirong

Creek Ave

Clary

Waring

Atterberry

Stewart

Little

Grove

Clary

Stewart

Curry Ave

Hardin Ave

Atterberry

Clary

Thomas Ave

Fairgrounds

Grosboll

Schirong

Creek Ave

Clary

Thomas Ave

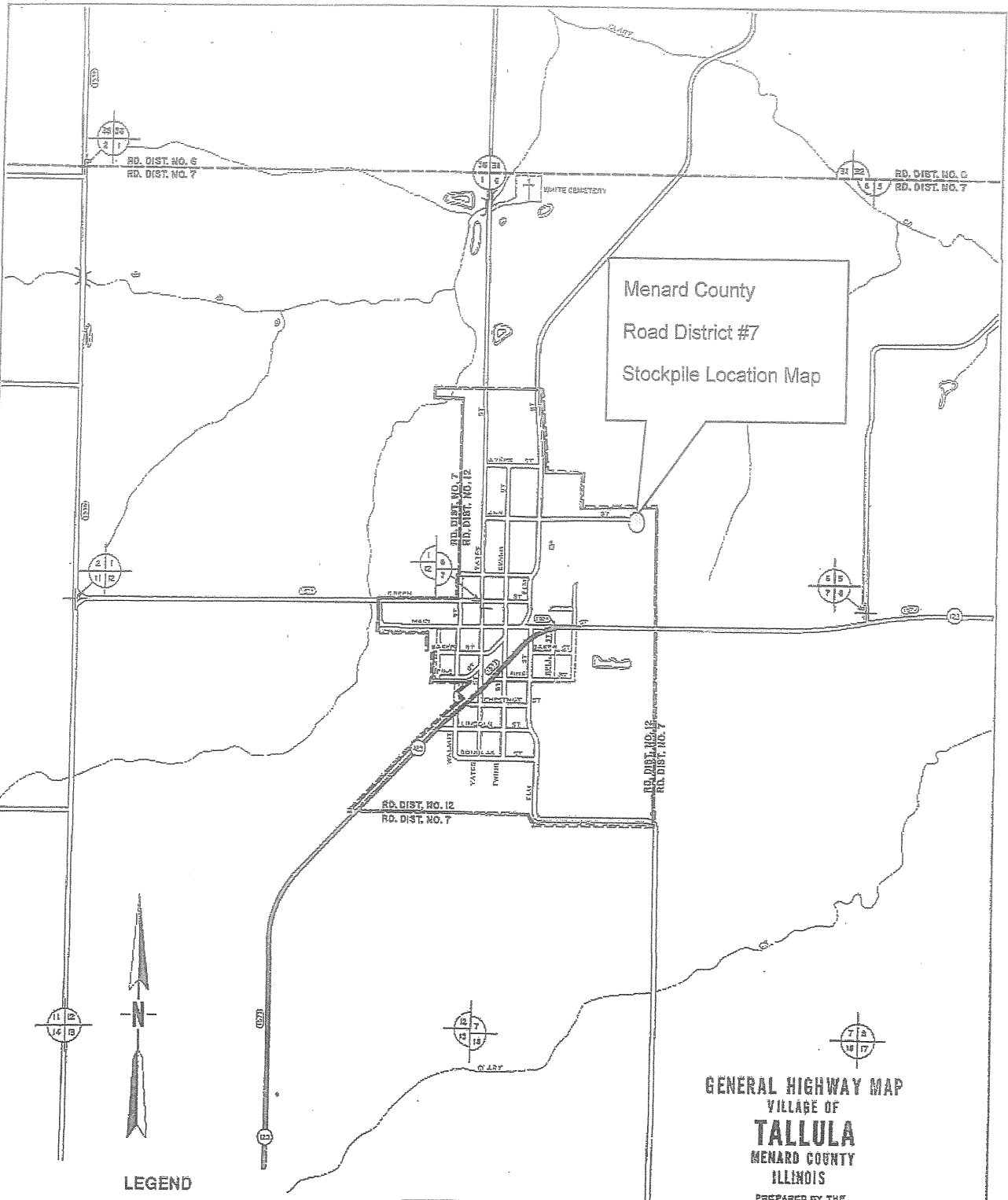

LEGEND

MARKED ROUTE:
U.S. ILL., INTERSTATE
STATE HIGHWAYS:
SUPPLEMENTAL
RURAL ROADS AND
MUNICIPAL STREETS
UNOPENED STREETS
COUNTY HIGHWAY EXT.
FEDERAL AID PRIMARY
FEDERAL AID SECONDARY
CORPORATE LIMITS

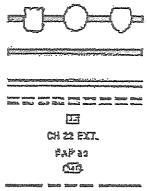

ORIGINAL DATA 1988	
REVISED	
BY	DATE
PH	12-21-88
PAB	12-21-88
PAB	12-21-88
PAB	12-21-88
PAB	12-21-88

GENERAL HIGHWAY MAP
VILLAGE OF
TALLULA
MENARD COUNTY
ILLINOIS

PREPARED BY THE
DEPARTMENT OF TRANSPORTATION
OFFICE OF PLANNING AND PROGRAMMING
IN COOPERATION WITH THE
U.S. DEPARTMENT OF TRANSPORTATION
FEDERAL HIGHWAY ADMINISTRATION

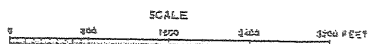

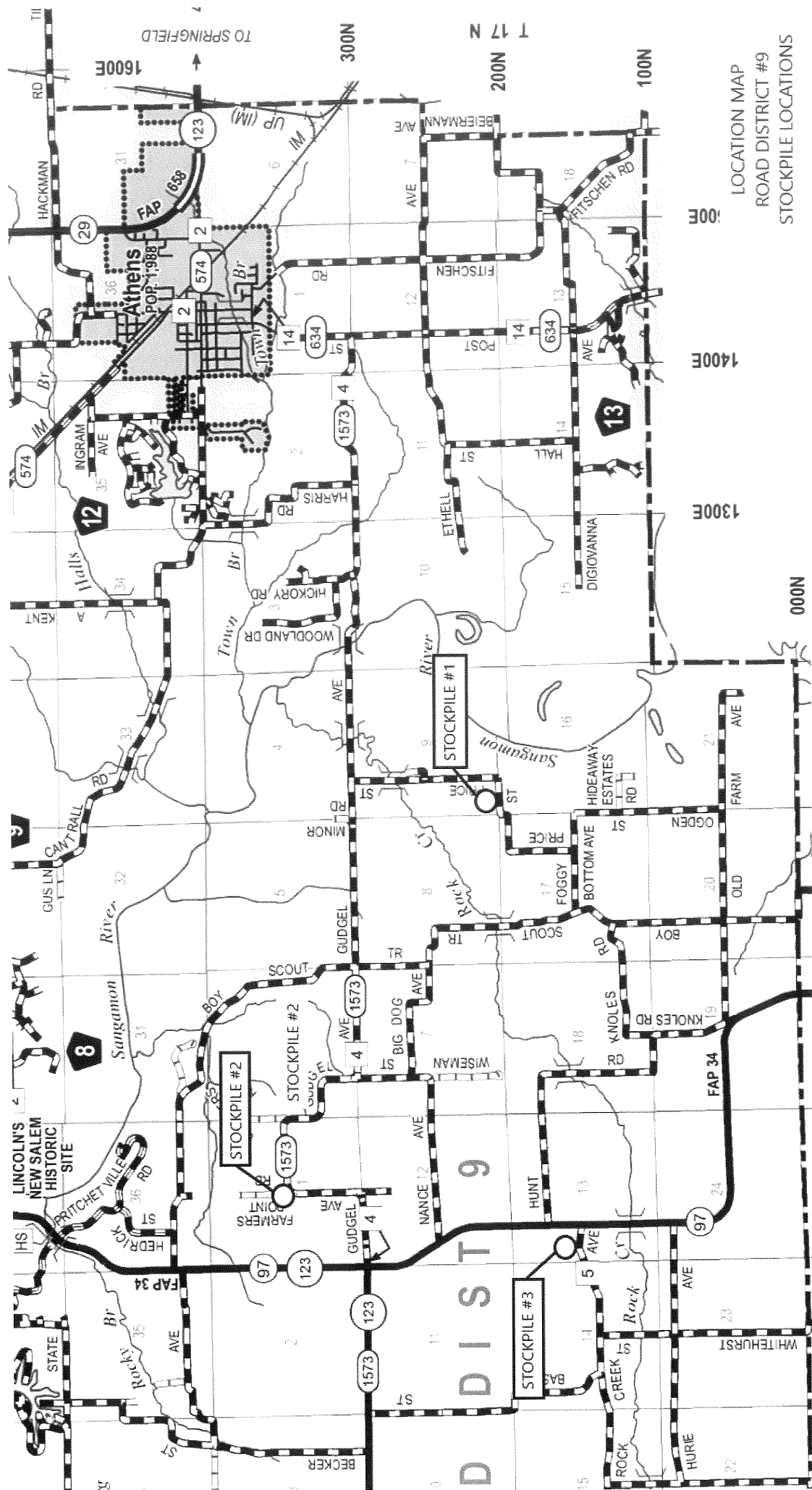



Local Public Agency

County

Section Number

Various Road Districts

Menard

21-XX000-00-GM

The Following Recurring Special Provisions Indicated By An "X" Are Applicable To This Contract And Are Included By Reference:

Recurring Special Provisions

<u>Check Sheet #</u>			<u>Page No.</u>
1	<input type="checkbox"/>	Additional State Requirements for Federal-Aid Construction Contracts	97
2	<input type="checkbox"/>	Subletting of Contracts (Federal-Aid Contracts)	100
3	<input type="checkbox"/>	EEO	101
4	<input type="checkbox"/>	Specific EEO Responsibilities Non Federal-Aid Contracts	111
5	<input type="checkbox"/>	Required Provisions - State Contracts	116
6	<input type="checkbox"/>	Asbestos Bearing Pad Removal	122
7	<input type="checkbox"/>	Asbestos Waterproofing Membrane and Asbestos HMA Surface Removal	123
8	<input type="checkbox"/>	Temporary Stream Crossings and In-Stream Work Pads	124
9	<input type="checkbox"/>	Construction Layout Stakes Except for Bridges	125
10	<input type="checkbox"/>	Construction Layout Stakes	128
11	<input type="checkbox"/>	Use of Geotextile Fabric for Railroad Crossing	131
12	<input type="checkbox"/>	Subsealing of Concrete Pavements	133
13	<input type="checkbox"/>	Hot-Mix Asphalt Surface Correction	137
14	<input type="checkbox"/>	Pavement and Shoulder Resurfacing	139
15	<input type="checkbox"/>	Patching with Hot-Mix Asphalt Overlay Removal	140
16	<input type="checkbox"/>	Polymer Concrete	142
17	<input type="checkbox"/>	PVC Pipeliner	144
18	<input type="checkbox"/>	Bicycle Racks	145
19	<input type="checkbox"/>	Temporary Portable Bridge Traffic Signals	147
20		Reserved	149
21	<input type="checkbox"/>	Nighttime Inspection of Roadway Lighting	150
22	<input type="checkbox"/>	English Substitution of Metric Bolts	151
23	<input type="checkbox"/>	Calcium Chloride Accelerator for Portland Cement Concrete	152
24	<input type="checkbox"/>	Quality Control of Concrete Mixtures at the Plant	153
25	<input type="checkbox"/>	Quality Control/Quality Assurance of Concrete Mixtures	161
26	<input type="checkbox"/>	Digital Terrain Modeling for Earthwork Calculations	177
27		Reserved	179
28	<input type="checkbox"/>	Preventive Maintenance - Bituminous Surface Treatment (A-1)	180
29		Reserved	186
30		Reserved	187
31		Reserved	188
32	<input type="checkbox"/>	Temporary Raised Pavement Markers	189
33	<input type="checkbox"/>	Restoring Bridge Approach Pavements Using High-Density Foam	190
34	<input type="checkbox"/>	Portland Cement Concrete Inlay or Overlay	193
35	<input type="checkbox"/>	Portland Cement Concrete Partial Depth Hot-Mix Asphalt Patching	197
36	<input type="checkbox"/>	Longitudinal Joint and Crack Patching	200
37	<input type="checkbox"/>	Concrete Mix Design - Department Provided	202

Local Public Agency

County

Section Number

Various Road Districts

Menard

21-XX000-00-GM

The Following Local Roads And Streets Recurring Special Provisions Indicated By An "X" Are Applicable To This Contract And Are Included By Reference:

Local Roads And Streets Recurring Special Provisions

<u>Check Sheet #</u>		<u>Page No.</u>
LRS 1	Reserved	204
LRS 2	<input type="checkbox"/> Furnished Excavation	205
LRS 3	<input type="checkbox"/> Work Zone Traffic Control Surveillance	206
LRS 4	<input type="checkbox"/> Flaggers in Work Zones	207
LRS 5	<input checked="" type="checkbox"/> Contract Claims	208
LRS 6	<input type="checkbox"/> Bidding Requirements and Conditions for Contract Proposals	209
LRS 7	<input checked="" type="checkbox"/> Bidding Requirements and Conditions for Material Proposals	215
LRS 8	Reserved	221
LRS 9	<input type="checkbox"/> Bituminous Surface Treatments	222
LRS 10	Reserved	223
LRS 11	<input checked="" type="checkbox"/> Employment Practices	224
LRS 12	<input type="checkbox"/> Wages of Employees on Public Works	226
LRS 13	<input checked="" type="checkbox"/> Selection of Labor	228
LRS 14	<input type="checkbox"/> Paving Brick and Concrete Paver Pavements and Sidewalks	229
LRS 15	<input checked="" type="checkbox"/> Partial Payments	232
LRS 16	<input type="checkbox"/> Protests on Local Lettings	233
LRS 17	<input type="checkbox"/> Substance Abuse Prevention Program	234
LRS 18	<input type="checkbox"/> Multigrade Cold Mix Asphalt	235



Local Public Agency	County	Section Number
Various Road Districts	Menard	21-__0000-00-GM

The following Special Provision supplement the "Standard Specifications for Road and Bridge Construction", adopted

April 1, 2016, the latest edition of the "Manual on Uniform Traffic Control Devices for Streets and Highways", and the "Manual of Test Procedures of Materials" in effect on the date of invitation of bids, and the Supplemental Specification and Recurring Special Provisions indicated on the Check Sheet included here in which apply to and govern the construction of the above named section, and in case of conflict with any parts, or parts of said Specifications, the said Special Provisions shall take precedence and shall govern.

NOTICE TO ALL BIDDERS:

Please mark the outside of the bid envelopes "2021 General Aggregates Letting, Menard Co. Road Districts".

The materials to be purchased as a result of this letting are for the use of Menard County, various Road Districts to accomplish their 2021 construction and maintenance programs. Pre-qualification of bidders shall NOT apply to this proposal.

A BID BOND will NOT be accepted for the proposal guaranty.

The bidder has to option of bidding any or all of the groups. The award will be made to the lowest responsible bidder for each group. The bidder may submit one proposal guaranty covering the total of the entire groups bid rather than a proposal guaranty for each group bid.

The successful bidder shall have the option of substituting a surety bond for the full amount of the award for his proposal guaranty or reducing the proposal guaranty to cover all those groups for which the bidder was low bidder.

All, part, or none of any group may be purchased. The County reserves the right to increase or decrease the quantity of materials. No allowance will be made in the unit price bid for any increase or decrease in quantities. The unit prices bid shall remain firm until December 31, 2021.

For the purpose of determining the low bidder, 15 cents per ton mile shall be used as a hauling differential. Mileage shall be from the source to the Road District's stockpile.

DISTRICT 6 – LOCAL ROADS & STREETS
SPECIAL PROVISIONS FOR
PROPOSAL GUARANTY and
SUPPLIERS COMMITMENT
Effective April 1, 2016

STANDARD SPECIFICATIONS:

All references to Sections or Articles in these specifications shall be construed to mean a specific Section or Article of the Standard Specifications for Road and Bridge Construction, adopted by the Illinois Department of Transportation on April 1, 2016.

(Please Mark All Applicable Check Boxes)

☒ **PROPOSAL GUARANTY**

All sections of either Check Sheet LRS 6 or LRS 7 of the "Supplemental Specifications and Recurring Special Provisions" remain in full force, except the section on the Proposal Guaranty.

A certified check, bank cashier's check (both hereafter called "check") or bank draft for the percentage of the amount of the bid, or for the amount specified in the following schedules, shall be submitted with all proposals. After award has been made, arrangements may be made to substitute a "check" or bank draft for the percentage of the amount of the award, or for the amount specified in the following schedule.

A bid bond ☐ will be allowed / ☒ will not be allowed.

Amount of Bid		<input checked="" type="checkbox"/> 5% or <input checked="" type="checkbox"/> Proposal Guaranty	<input type="checkbox"/> 10% or <input type="checkbox"/> Proposal Guaranty
	Up to 5,000	\$150	\$ 300
\$ 5,000	10,000	300	500
10,000	50,000	1,000	2,500
50,000	100,000	3,000	5,000
100,000	150,000	5,000	7,500
150,000	250,000	7,500	12,500
250,000	500,000	12,500	25,000
500,000	1,000,000	25,000	50,000
1,000,000	1,500,000	50,000	75,000
1,500,000	2,000,000	100,000	100,000
2,000,000	3,000,000	150,000	150,000
3,000,000	5,000,000	200,000	200,000
5,000,000	7,500,000	300,000	300,000
7,500,000	10,000,000	400,000	400,000
10,000,000	15,000,000	500,000	500,000
15,000,000	20,000,000	600,000	600,000
20,000,000	25,000,000	700,000	700,000
25,000,000	30,000,000	800,000	800,000
30,000,000	35,000,000	900,000	900,000
over	35,000,000	1,000,000	1,000,000

All "checks" and bank drafts shall be made payable to the Menard County Treasurer. The unsuccessful bidder(s) "checks" or bank drafts shall be returned at the time of the award.

The successful bidder(s) "check" or bank draft shall be held to insure prompt and faithful performance of the provisions of this agreement. The same shall be returned to the successful bidder(s) after satisfactory delivery of the materials has been made.

Failure on the part of the successful bidder(s) to make satisfactory delivery of the materials within 10 days from the date of the notice to ship the materials will be considered as just cause for the forfeiture of the "check" or bank draft to the Menard County Treasurer.

The successful bidder(s) may substitute a surety bond for the full amount of the award in lieu of the proposal guarantee after award and with the approval of the Menard County Board of Commissioners.

TERMINATION OF CONTRACT:

It is understood that this agreement shall terminate on December 31, 2021.

☐ **SUPPLIERS COMMITMENT**

Any bidder who does not furnish the Bituminous Materials or Seal Coat Aggregate from their own plant or quarry shall supply a commitment from a supplier that will furnish that material to the bidder. The commitment is for quantity of material only---price is between the bidder and the supplier. The quantity of material covered in the commitment shall be the quantity bid for each type of material plus 50% for possible overrun. This commitment is to be submitted with the bid. NO BID WILL BE READ IF IT IS NOT ENCLOSED.

State of Illinois
Department of Transportation
Bureau of Local Roads and Streets

SPECIAL PROVISION
FOR
INSURANCE

Effective: February 1, 2007
Revised: August 1, 2007

All references to Sections or Articles in this specification shall be construed to mean specific Section or Article of the Standard Specifications for Road and Bridge Construction, adopted by the Department of Transportation.

The Contractor shall name the following entities as additional insured under the Contractor's general liability insurance policy in accordance with Article 107.27:

Menard County Highway Department

Menard County Road District 1

Menard County Road District 7

Menard County Road District 2

Menard County Road District 9

Menard County Road District 3

Menard County Road District 10

Menard County Road District 4

Menard County Road District 5

Menard County Road District 6

The entities listed above and their officers, employees, and agents shall be indemnified and held harmless in accordance with Article 107.26.

DISTRICT 6 – LOCAL ROADS & STREETS
SPECIAL PROVISIONS FOR
SEAL COAT AGGREGATE (CA XX)
PRE-COAT SEAL COAT AGGREGATE (CA XX)
Effective April 1, 2016

STANDARD SPECIFICATIONS:

All references to Sections or Articles in these specifications shall be construed to mean a specific Section or Article of the Standard Specifications for Road and Bridge Construction, adopted by the Illinois Department of Transportation on April 1, 2016.

MATERIAL:

All materials shall conform to Section 1004 and 1032. The producer may substitute approved CM xx; instead of the CA xx as part of the "Aggregate Gradation Control System" (AGCS).

EQUIPMENT:

All equipment shall be in first class condition and shall be of an approved type. Unless otherwise specified, the following equipment shall be used and shall meet the following requirements:

The aggregate shall be spread by means of an aggregate spreader conforming to Article 1102.04.

The mechanical sweeper shall conform to Article 1101.03.

The roller shall conform to Article 1101.01 (a) Pneumatic-Tired Rollers or (c) Self Propelled Pneumatic-Tired Rollers.

(Please Mark All Applicable Check Boxes)

CONSTRUCTION METHODS:

The methods used in performing the work shall be as follows:

Immediately after the bituminous material has been applied, aggregate shall be spread over the treated surface at the rate of _____ to _____ pounds per square yard.

The contractor ☐ will / ☐ will not be required to provide sweeping as specified in Section 403.

The contractor ☐ will / ☐ will not be required to provide rolling as specified in Section 403.

SEAL COAT AGGREGATE (CA XX)

- ☒ CA 13
- ☐ CA 14
- ☐ CA 15
- ☒ CA 16

MATERIAL:

The aggregate for the surface treatment shall consist of clean, hard, durable particles of gravel or crushed stone substantially free from foreign material, and when a representative sample is tested with laboratory sieves, it shall conform to the above gradation(s).

The quality shall be ☒ Class C or better / ☐ Class D or better.

When D quality is specified, the percent passing the #200 sieve shall be 0-4.0%, AASHTO T 11 (IL modified)

BASIS OF PAYMENT:

The work shall be paid for at the contract unit price per ton for **SEAL COAT AGGREGATE (CA XX)**, which price shall be payment in full for furnishing all materials either **FOB Trucks at Source** or **Stockpile** or **Delivered & Installed** as indicated on BLR 12241 "Material Proposal Schedule of Prices". The price for **Delivered & Installed** shall include the cost of sweeping and rolling, if required and no additional compensation will be given.

☐ **PRE-COAT SEAL COAT AGGREGATE (CA XX)**

DESCRIPTION:

This work shall consist of mixing asphalt and an approved aggregate in a hot mix plant or a pug mill.

MATERIALS:

The aggregate gradation shall be ☐ CA 13 ☐ CA 14 ☐ CA 15 ☐ CA 16.

The quality shall be ☐ Class C or better / ☐ Class D or better.

When D quality is specified, the percent passing the #200 sieve shall be 0-4.0%, AASHTO T 11 (IL modified)

The bituminous material shall be ☐ PG46-28 ☐ PG52-28 ☐ PG58-28
☐ SS-1 ☐ CSS-1 ☐ SC-70 ☐ HFE-150.

EQUIPMENT:

The hot mix plant or pug mill shall meet the requirements of Article 1102. The pug mill shall be a twin shaft mixer equipped with aggregate and asphalt measuring devices and approved by the Engineer.

GENERAL:

The bituminous material and the aggregate shall be mixed until all aggregate is uniformly coated without excess. The amount of asphalt will vary according to porosity and amount of dust, but in no case shall it be less than ½% or more than 1-½% residual asphalt by weight of aggregate. The same gradation of aggregate and grade of bituminous materials shall be used throughout all work involving pre-coated aggregate.

It shall be the responsibility of the Contractor to provide a sample of the pre-coated material to the District 6 Materials in Springfield or Quincy for determination of the asphalt content.

BASIS OF PAYMENT:

The work shall be paid for at the contract unit price per ton for **SEAL COAT AGGREGATE (PRE-COAT) (CA XX)**, which price shall be payment in full for furnishing all materials either **FOB Trucks at Source or Stockpile or Delivered & Installed** as indicated on BLR 12241 "Material Proposal Schedule of Prices". The price for **Delivered & Installed** shall include the cost of sweeping and rolling, if required and no additional compensation will be given.

-
-
- ☐ **SEAL COAT AGGREGATE (CA XX)**
☐ **COURSE AGGREGATE FOR BITUMINOUS COURSE, CLASS A**

The aggregate for the surface treatment shall consist of clean, hard, durable particles of gravel or crushed stone substantially free from foreign material and shall conform to Article 1004.04. The aggregate shall be tested to Article 1004.01(b) and meet the following quality requirements:

- ☐ The quality shall be Class D or better or
- ☐ The quality shall be less than Class D meeting the following:
1. The maximum allowable Sodium Sulfate Soundness Loss is 30%.
 2. The maximum allowable L.A. Abrasion Loss is 60%.
 3. Revise the gradation table of Article 1004.03(c) to include CM 15 for seal coat use in Class A-1

The percent passing the #200 sieve shall be 0-4.0%, AASHTO T 11 (IL modified)

BASIS OF PAYMENT:

The work shall be paid for at the contract unit price per ton for:

- ☐ **CA 13**
☐ **CA 14**
☐ **CA 15**
☐ **CA 16**

which price shall be payment in full for furnishing all materials either **FOB Trucks at Source or Stockpile or Delivered & Installed** as indicated on BLR 12241 "Material Proposal Schedule of Prices". If this material is to be delivered from more than one location, the exact location of each delivery point shall be clearly indicated in the space provided.

DISTRICT 6 – LOCAL ROADS & STREETS
SPECIAL PROVISIONS FOR
ROCKFILL (PRIMARY CRUSHER RUN),
RIPRAP 1,
COARSE AGGREGATE, 3" (CA 1),
AGGREGATE BASE REPAIR (CA 3),
AGGREGATE (CA 6),
AGGREGATE SURFACE COURSE (CA 7),
AGGREGATE SURFACE COURSE (CA 8) and
AGGREGATE SURFACE COURSE (FURNISHED) (CA xx)
Effective April 1, 2016

STANDARD SPECIFICATIONS:

All references to Sections or Articles in these specifications shall be construed to mean a specific Section or Article of the Standard Specifications for Road and Bridge Construction, adopted by the Illinois Department of Transportation on April 1, 2016.

MATERIAL:

All materials shall conform to Section 1004 and 1005. The producer may substitute approved CM xx; instead of the CA xx as part of the "Aggregate Gradation Control System" (AGCS).

(Please Mark All Applicable Check Boxes)

☐ **ROCKFILL (PRIMARY CRUSHER RUN)**

Primary Crusher Run shall be the end result of the material produced through the primary crusher. The material shall be produced in such a manner to produce a well-graded product with sufficient fines and small particles to fill the voids when in place. *(Note for Designer: This Rockfill specification has a higher quality requirement than Article 1005.01(b)(2).)*

Rockfill shall be quarried from a ledge approved for Class B Quality riprap.

BASIS OF PAYMENT:

This work shall be paid for at the unit price per ton for **ROCKFILL (PRIMARY CRUSHER RUN)**, which price shall be payment in full for furnishing all materials either **FOB Trucks at Source** or **Stockpile** as indicated on BLR 12241 "Material Proposal Schedule of Prices".

☐ **RIPRAP RR1**

The quality shall be Class B or better.

BASIS OF PAYMENT:

This work shall be paid for at the unit price per ton for **RIPRAP RR1**, which price shall be payment in full for furnishing all materials either **FOB Trucks at Source** or **Stockpile** as indicated on BLR 12241 "Material Proposal Schedule of Prices".

☐ **COARSE AGGREGATE, 3" (CA 1)**

The quality shall be ☐ Class C or better / ☐ Class D or better.

BASIS OF PAYMENT:

This work shall be paid for at the unit price per ton for **COARSE AGGREGATE, 3" (CA 1)**, which price shall be payment in full for furnishing all materials either **FOB Trucks at Source** or **Stockpile** as indicated on BLR 12241 "Material Proposal Schedule of Prices".

☐ **AGGREGATE BASE REPAIR (CA 3)**

The quality shall be ☐ Class C or better / ☐ Class D or better.

BASIS OF PAYMENT:

This work shall be paid for at the unit price per ton for **AGGREGATE BASE REPAIR (CA 3)**, which price shall be payment in full for furnishing all materials either **FOB Trucks at Source** or **Stockpile** as indicated on BLR 12241 "Material Proposal Schedule of Prices".

☐ **AGGREGATE (CA 6)**

The computation of quantities for CA 6 is based on the use of limestone in order to produce a certain volume of material. Slags and other materials meeting the specifications for CA 6 may have appreciably different specific gravities, thereby significantly altering the desired volume.

Therefore, if materials other than limestone are to be provided, a comparison of bid prices will be made. The low bid will be determined by multiplying the unit bid price by the ratio of the specific gravity of the non-limestone material to that of limestone.

Specific gravities of the materials known to meet the CA 6 specifications which will be used in the aforementioned computation are:

Limestone	2.67
Air Cooled Blast Furnace Slag	2.30
Copper Slag	3.60
Gravel	2.52

☐ The quality shall be Class D or better.

BASIS OF PAYMENT:

This work shall be paid for at the unit price per ton for **AGGREGATE (CA 6)**, which price shall be payment in full for furnishing all materials either **FOB Trucks at Source** or **Stockpile** as indicated on BLR 12241 "Material Proposal Schedule of Prices".

☐ **AGGREGATE SURFACE COURSE (CA 7)**

The quality shall be ☐ Class C or better / ☐ Class D or better.

BASIS OF PAYMENT:

The work shall be paid for at the unit price per ton for **AGGREGATE SURFACE COURSE TYPE B, (CA 7)**, which price shall be payment in full for furnishing all materials either **FOB Trucks at Source or Stockpile** as indicated on BLR 12241 "Material Proposal Schedule of Prices".

☐ **AGGREGATE SURFACE COURSE (CA 8)**

The plasticity index ☐ will / ☐ will not apply.

☐ The quality shall be Class D or better.

BASIS OF PAYMENT:

This work shall be paid for at the contract unit price per ton for **AGGREGATE SURFACE COURSE TYPE B, (CA 8)**, which price shall be payment in full for furnishing all materials either **FOB Trucks at Source or Stockpile** as indicated on BLR 12241 "Material Proposal Schedule of Prices".

☒ **AGGREGATE SURFACE COURSE (FURNISHED), (CA xx)**

The aggregate for the surface treatment shall consist of clean, hard, durable particles of gravel or crushed stone substantially free from foreign material. The aggregate shall be tested to Article 1004.01(b) and meet the following quality requirements:

☒ The quality shall be Class D or better or

☐ The quality shall be less than Class D meeting the following:

1. The maximum allowable Sodium Sulfate Soundness Loss is 40%.
2. The maximum allowable L.A. Abrasion Loss is 50%.
3. The sum of the percentage of Sodium Sulfate Soundness Loss and the L.A. Abrasion Loss, shall not exceed 80%.

BASIS OF PAYMENT:

The work shall be paid for at the contract unit price per ton for:

- ☒ **AGGREGATE SURFACE COURSE (FURNISHED), (CA 6)**
- ☒ **AGGREGATE SURFACE COURSE (FURNISHED), (CA 7)**
- ☐ **AGGREGATE SURFACE COURSE (FURNISHED), (CA 8)**
- ☒ **AGGREGATE SURFACE COURSE (FURNISHED), (CA 9)**
- ☐ **AGGREGATE SURFACE COURSE (FURNISHED), (CA 10)**

which price shall be payment in full for furnishing all materials either **FOB Trucks at Source** or **Stockpile** as indicated on BLR 12241 "Material Proposal Schedule of Prices".

- ☐ **AGGREGATE SURFACE COURSE (FURNISHED), (CA xx)**
- ☐ **BASE COURSE**
- ☐ **SHOULDER AGGREGATE**

The aggregate for the surface treatment shall consist of clean, hard, durable particles of gravel or crushed stone substantially free from foreign material. The quality shall be Class D or better. The aggregate shall be tested to Article 1004.04 and meet the following quality requirements:

- ☐ The quality shall be Class D or better or
- ☐ The quality shall be less than Class D meeting the following:
 1. The maximum allowable Sodium Sulfate Soundness Loss is 40%.
 2. The maximum allowable L.A. Abrasion Loss is 50%.
 3. The sum of the percentage of Sodium Sulfate Soundness Loss and the L.A. Abrasion Loss, shall not exceed 80%.

BASIS OF PAYMENT:

The work shall be paid for at the contract unit price per ton for:

- ☐ **AGGREGATE SURFACE COURSE (FURNISHED), (CA xx)**
- ☐ **BASE COURSE**
- ☐ **SHOULDER AGGREGATE**

which price shall be payment in full for furnishing all materials either **FOB Trucks at Source** or **Stockpile** as indicated on BLR 12241 "Material Proposal Schedule of Prices".

Menard County
Road District #2
Special Provision

Aggregate Delivered and Installed Special Provision – Method of Installation

In addition to District 6 Local Roads and Streets Special Provisions for Pre-Coat Seal Coat Aggregate:

EQUIPMENT:

Aggregate shall be delivered and placed to the specified locations below by means of equipment in first class condition.

CONSTRUCTION METHOD:

Equipment must be able to place aggregate uniformly over the roadway tailgating the aggregate with tandem dump trucks. Equipment to be used must be approved by the County Engineer and Road District #2 Highway Commissioner. Roadway locations are 20 feet wide. Aggregate placement will be variable depth up to 2 inches thick.

LOCATIONS:

Roadway	Start	Installation Length	End
Coady St	0.71 miles north of Winterbauer Ave	7,920 ft @ 20 ft wide	0.26 miles south of Honey Heart Rd
Honey Heart Rd	0.25 miles east of Peoria Rd	6,864 ft @ 20 ft wide	Logan County Line Rd

BASIS OF PAYMENT:

The work shall be paid for at the contract unit price per ton for **AGGREGATE FURNISHED AND APPLIED**, which price shall be payment in full for furnishing all aggregate FOB Stockpile to the locations and placing per the special provision.